

Jason Control Vans

Initial Suggestions/Questions (1 of 3)

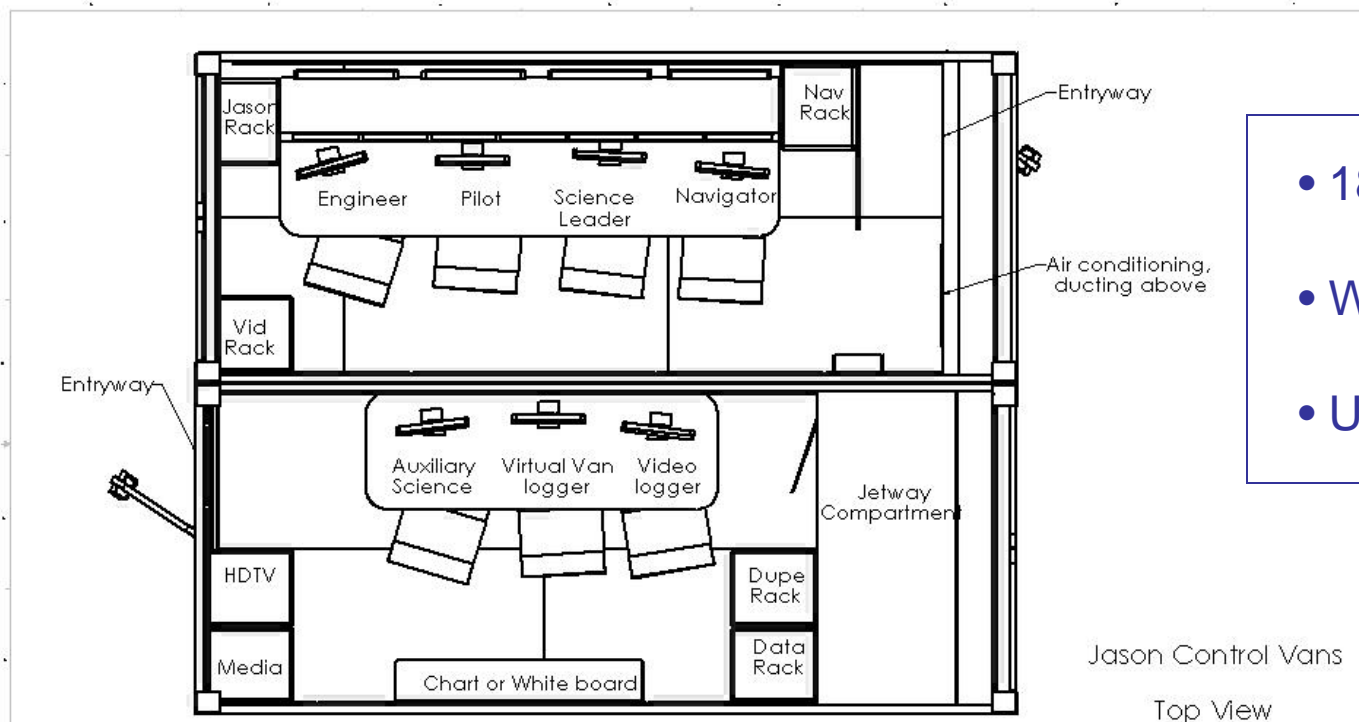

- 180° Rotation
- Watch-Leader
- Use Head-Sets?

Matt Heintz
WHOI
(508) 289-3426

NO	DESCRIPTION	DATE	BY
1	Deep Submergence Lab		
2	Jason Control Van layout		
3			
4			
5			
6			
7			
8			
9			
10			
11			
12			
13			
14			
15			
16			
17			
18			
19			
20			
21			
22			
23			
24			
25			
26			
27			
28			
29			
30			
31			
32			
33			
34			
35			
36			
37			
38			
39			
40			
41			
42			
43			
44			
45			
46			
47			
48			
49			
50			



Jason Control Vans

Initial Suggestions/Questions (2 of 3)

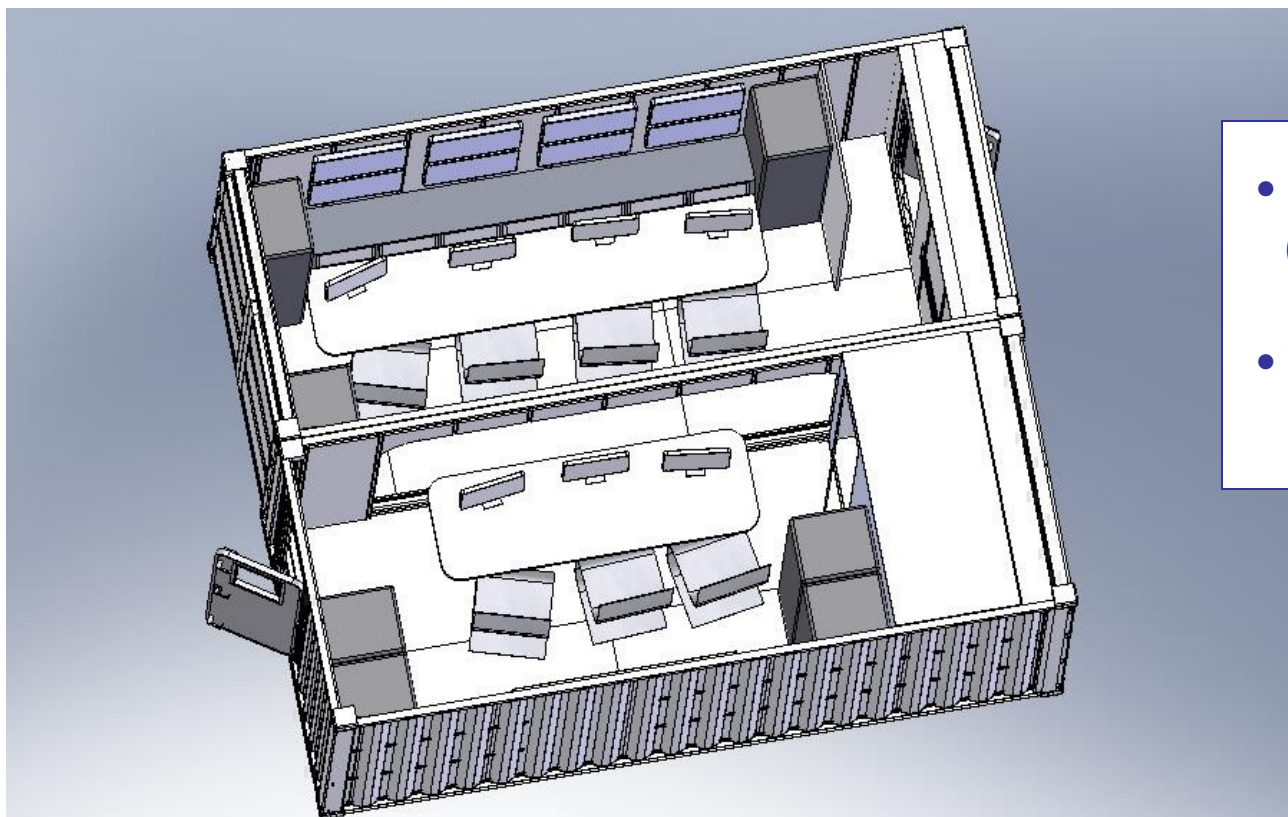

- 8 x 29" HD Flat Screens (2 for Science)
- Watch leader closer to data-loggers



Jason Control Vans

Initial Suggestions/Questions (3 of 3)

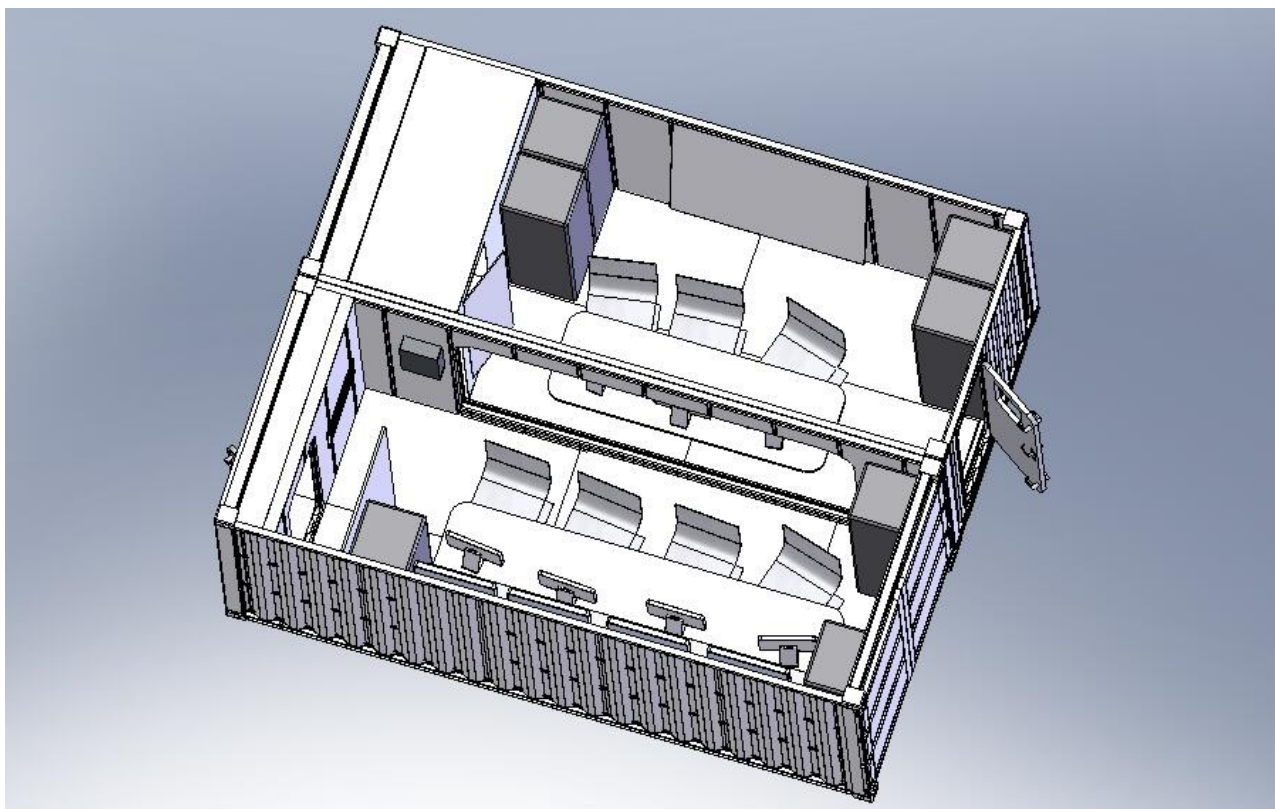

- 3rd Sci position?
- Chart displays:
table or wall mount?
- More scientists in-van
or better external
communications?



Jason Control Vans

Feedback (25 responses from UNOLS/DESSC)

- Science Leader position needed - set back from pilot/navigator
 - HD flat-screens: should be bigger! 29" not big enough
 - Floor plan: good; use of headsets: mixed reviews
 - Auxiliary position: needed, but can bring own laptop (sensors)
 - Chart table important too: tilting on rear wall = not enough
 - Extra scientists = seating at rear; line-of-sight OK?
-
- Two small low-cost monitors for Watch Leader (logging feeds)
 - External feed should include large split-screen video & audio



Jason Control Vans

Revised Plan (1 of 4)

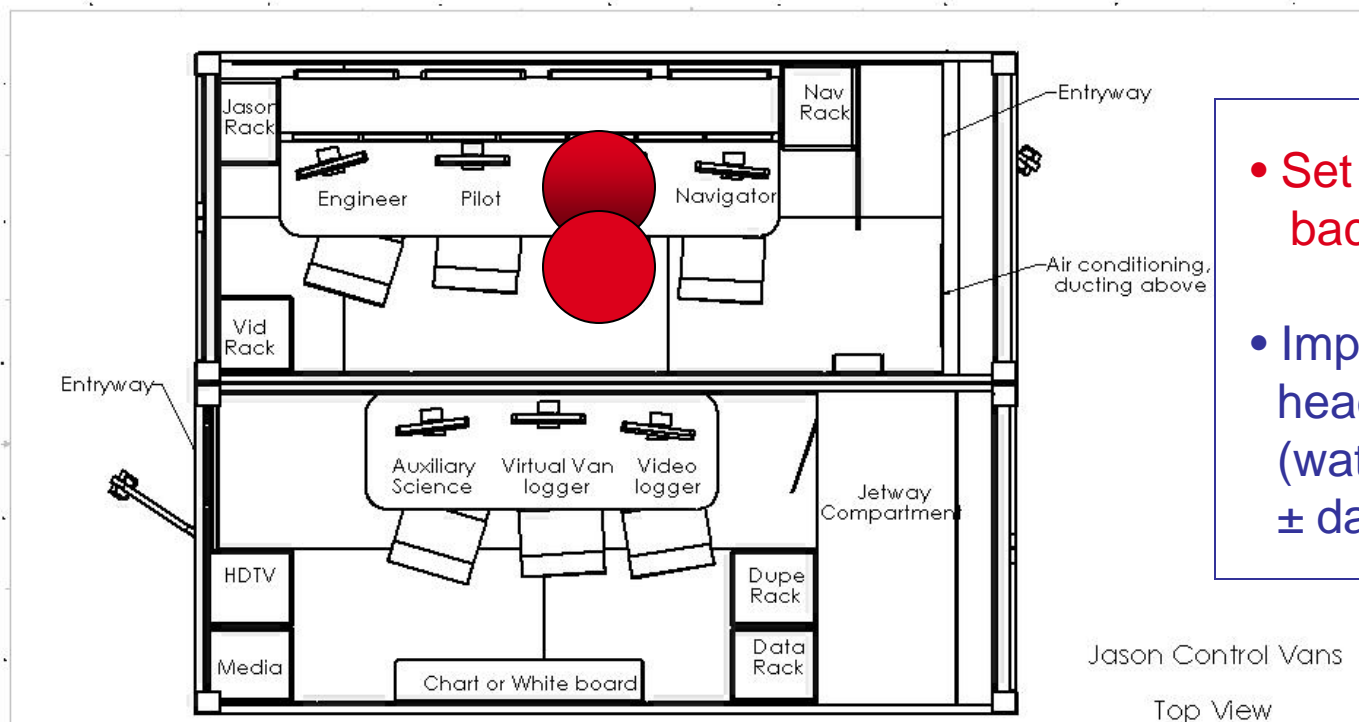

- Set watch-leader back from pilot etc.
- Implement (wireless) headsets as optional (watch leader ± pilot ± data-loggers)

Matt Heintz
WHOI
(508) 289-3426

NO	DESCRIPTION	DATE	BY
1	Deep Submergence Lab		
2	Jason Control Van layout		
3			
4			
5			
6			
7			
8			
9			
10			
11			
12			
13			
14			
15			
16			
17			
18			
19			
20			
21			
22			
23			
24			
25			
26			
27			
28			
29			
30			
31			
32			
33			
34			
35			
36			
37			
38			
39			
40			
41			
42			
43			
44			
45			
46			
47			
48			
49			
50			



Jason Control Vans

Revised Plan (2 of 4)

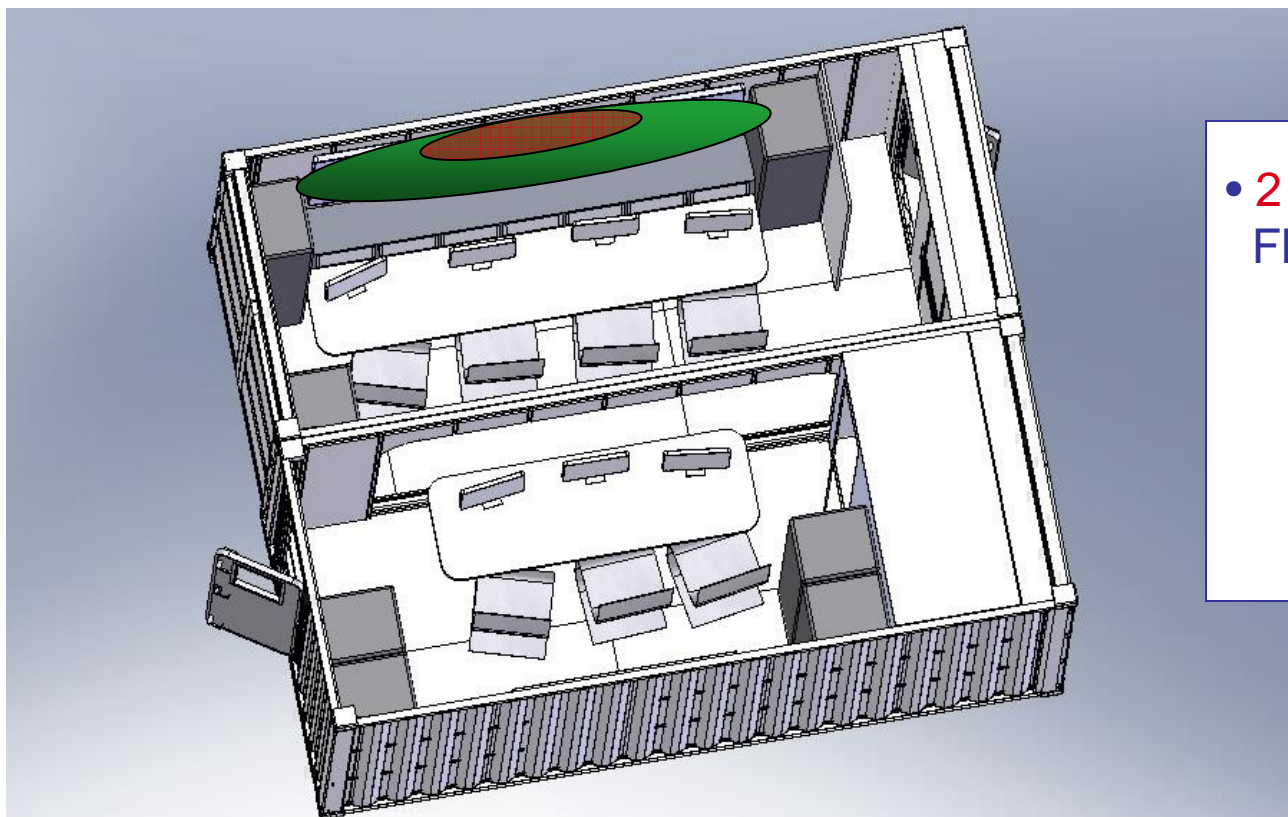

- 2 x 42" & 6 x 32" HD Flat Screens



Jason Control Vans

Revised Plan (2 of 4)

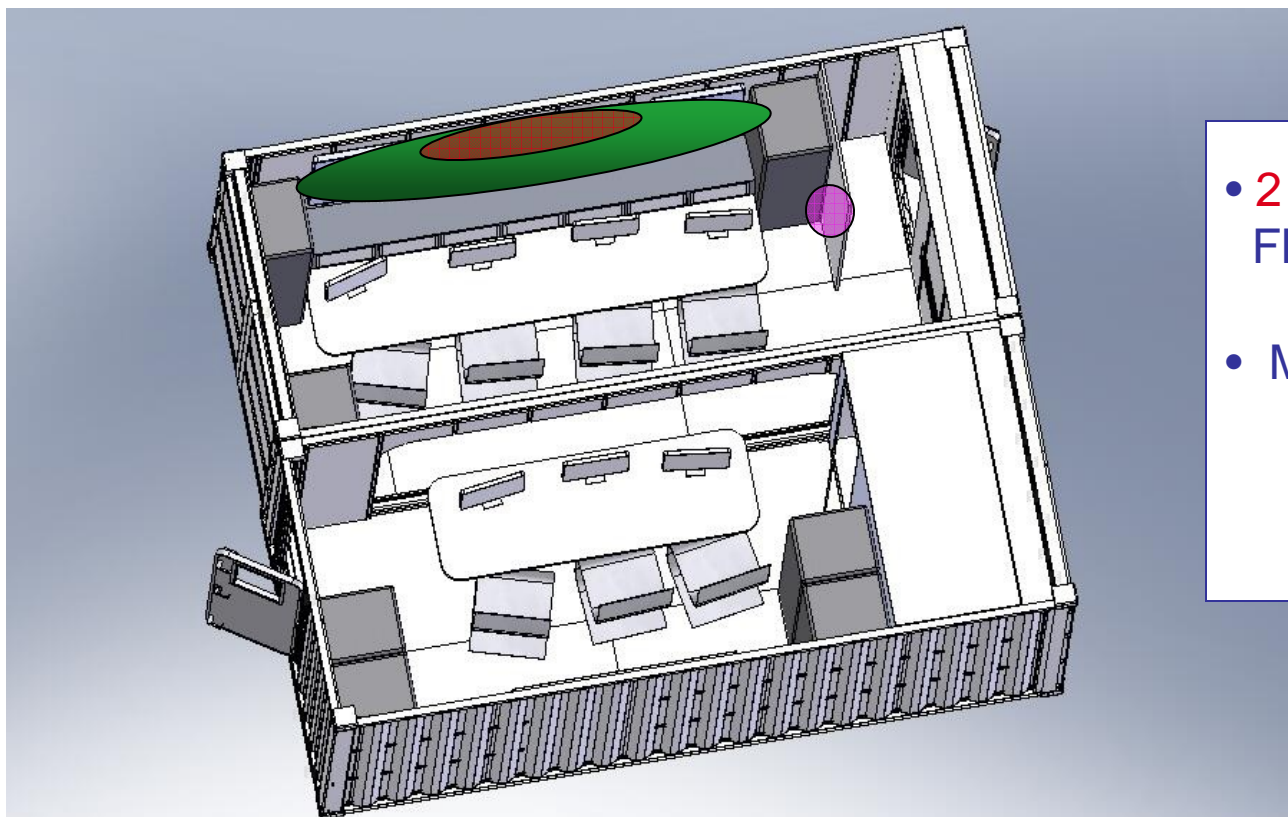

- 2 x 42" & 6 x 32" HD Flat Screens
- Magnetic white-board



Jason Control Vans

Revised Plan (2 of 4)

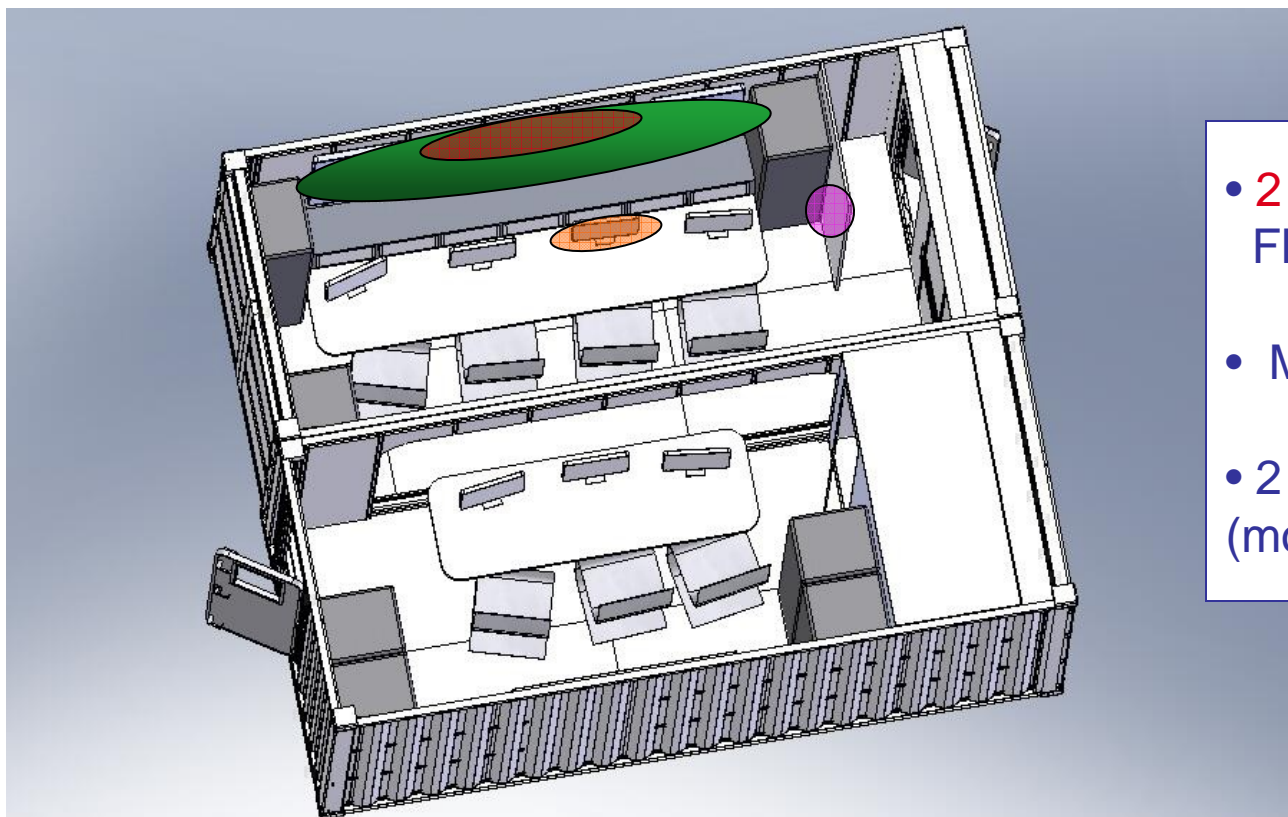

- 2 x 42" & 6 x 32" HD Flat Screens
- Magnetic white-board
- 2 Watch Ldr mini-screens (monitors data-logger feed)



Jason Control Vans

Revised Plan (3 of 4)

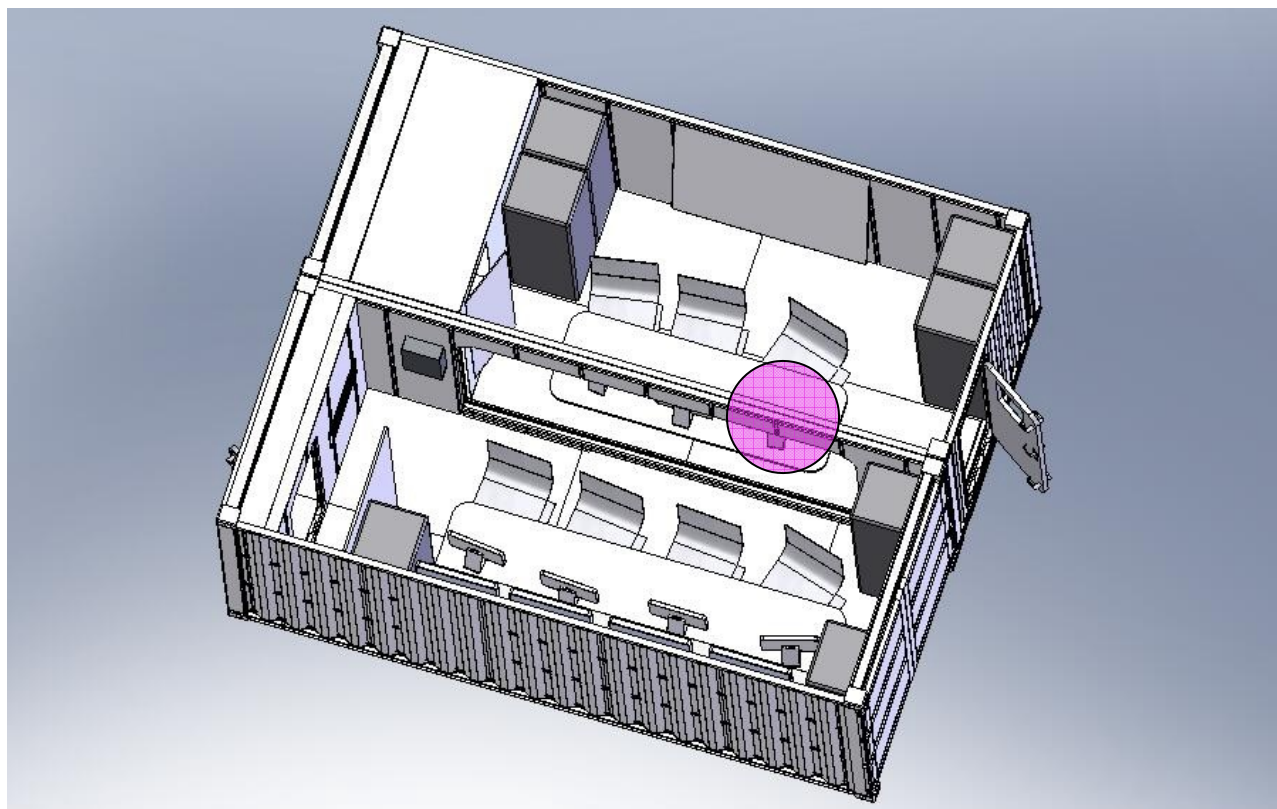

- Flat table w/cables that can fold away (laptop/charts/space)



Jason Control Vans

Revised Plan (3 of 4)

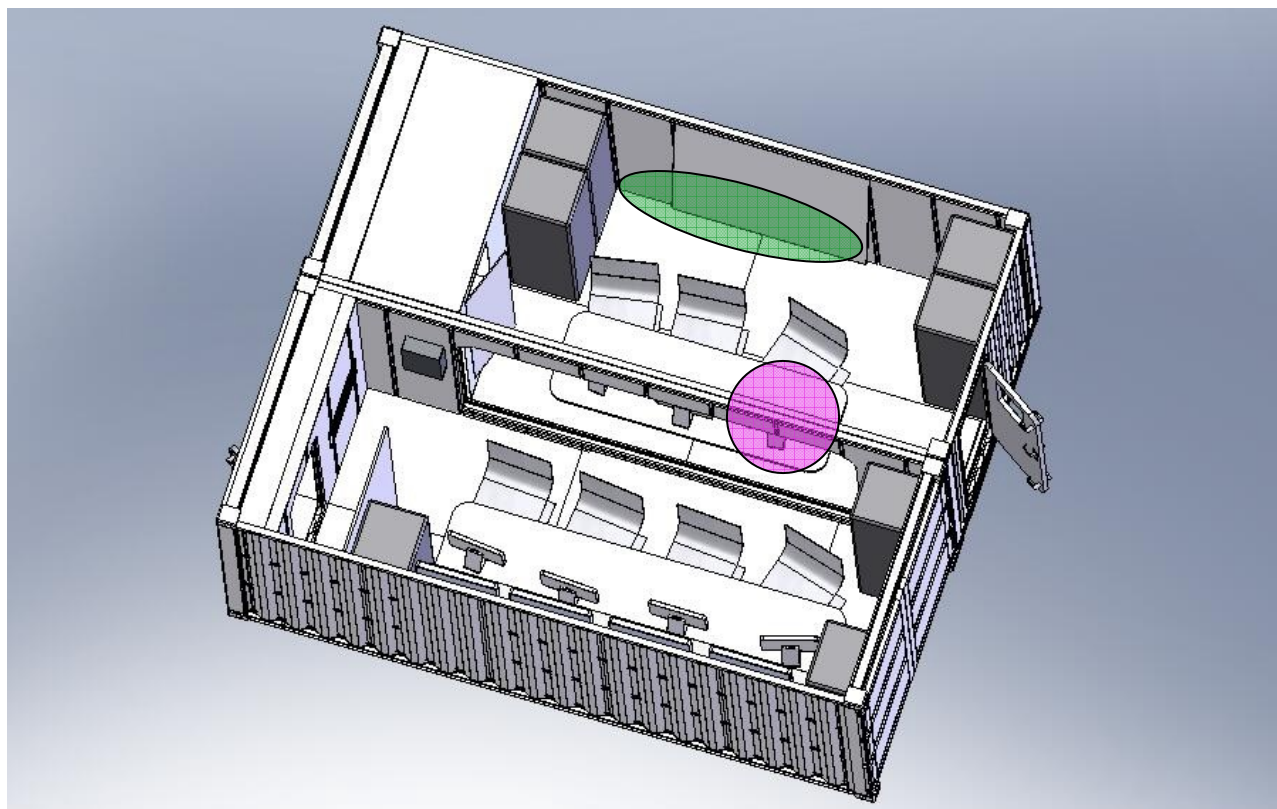

- Fold-down seats (3)
- Flat table w/cables that can fold away (laptop/charts/space)



Jason Control Vans

Revised Plan (3 of 4)

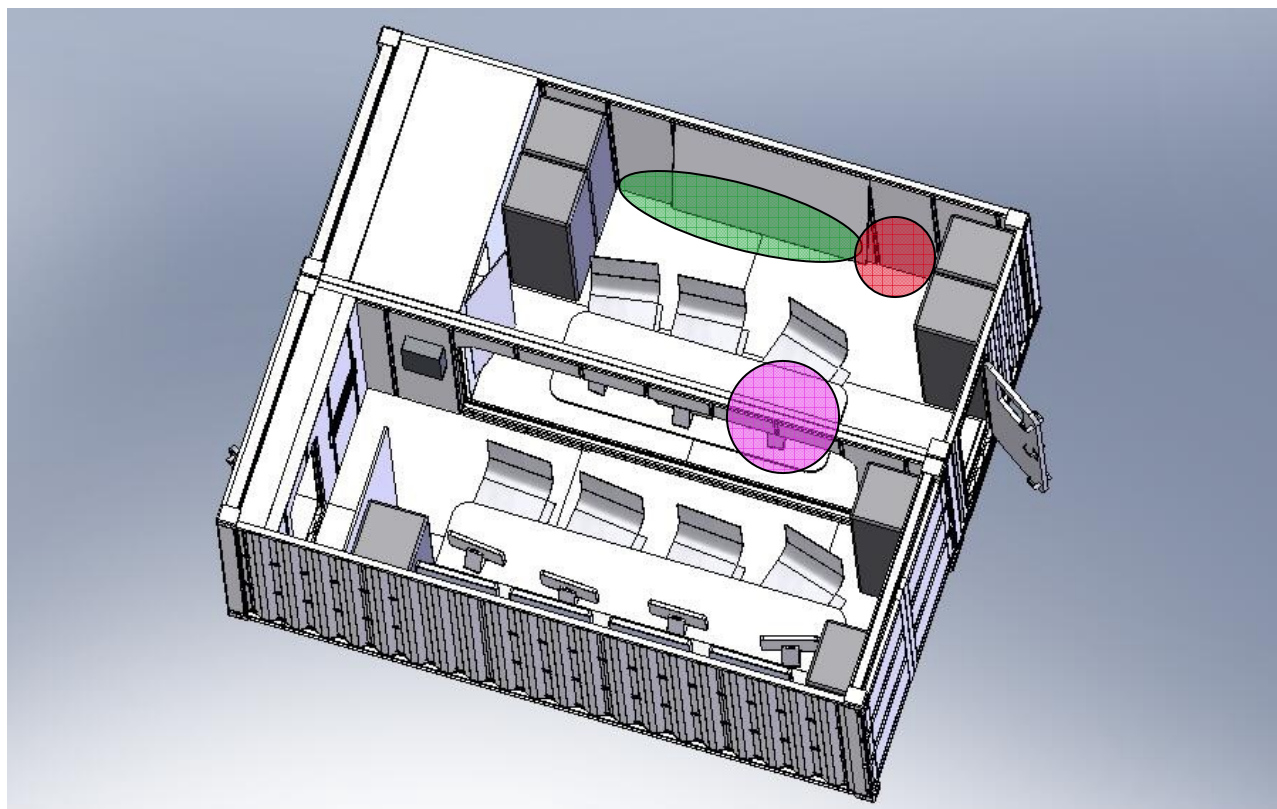

- Fold-down chart-table
- Fold-down seats (3)
- Flat table w/cables that can fold away (laptop/charts/space)



Jason Control Vans

Revised Plan (4 of 4)

External Feed Upgrades

- Video: 42" HD flat-screen in split-screen mode
 - very successful with ROV *Quest* (Germany)
 - provides spare for larger in-van screens
- Audio: one-way feed *from* van; **recorded?**

